

INNOVATIVE X-TENDER STAND

ASSEMBLY INSTRUCTIONS (schematic reference on back)



1
Install (4) **Total-Lock Caster Wheels** into **Leg Assembly**.
Lock wheels as shown.

CASTER WHEELS - P/N 4TLCW
LEG ASSEMBLY - P/N ES-001

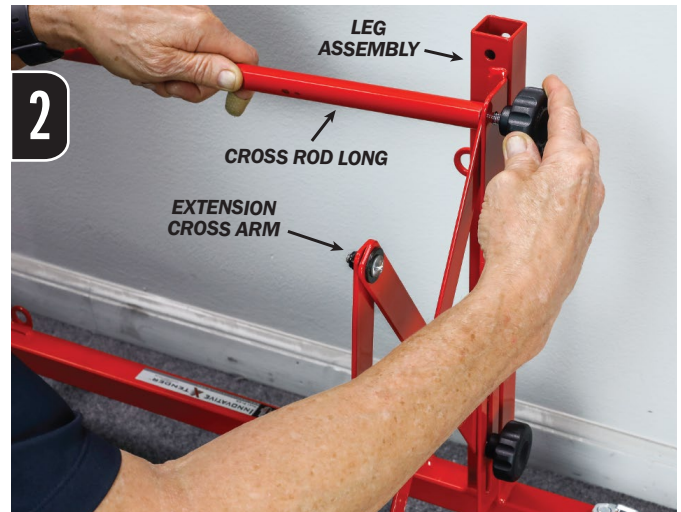

2
Install **Extension Cross Arm** assembly to **Leg Assembly**
using **Cross Rod Long** and plastic hand knobs.

EXTENSION CROSS ARM ASSEMBLY - P/N ES-004
LEG ASSEMBLY - P/N ES-001
CROSS ROD LONG - P/N ES-002
PLASTIC HAND KNOB - P/N 250-026



3
Install **Cross Rod Short** to **Extension Cross Arm**.

CROSS ROD SHORT - P/N ES-003
PLASTIC HAND KNOB - P/N 250-026

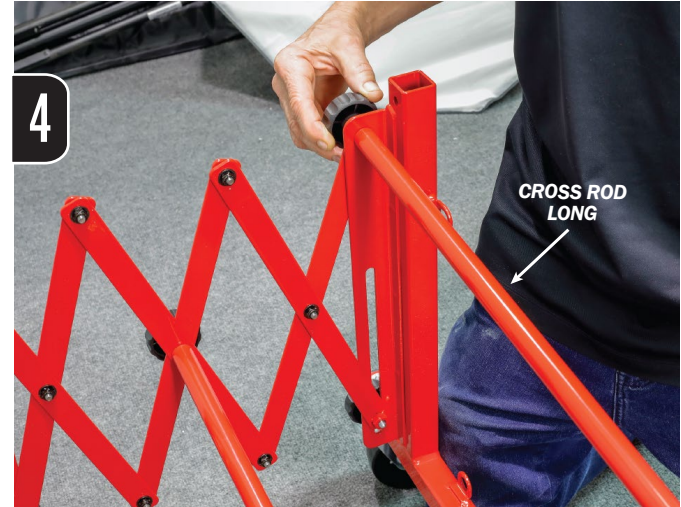

4
Repeat Steps 2-3 for **Second Leg Assembly** - then insert
(2) padded support frame assemblies into the top of stand.

LEG ASSEMBLY - P/N ES-001
EXTENSION CROSS ARM ASSEMBLY - P/N ES-004
PLASTIC HAND KNOB - P/N 250-026
PADDED SUPPORT FRAME ASSEMBLY - P/N ES-005



INNOVATIVE
TOOLS & TECHNOLOGIES, INC.
2016 GATEWAY CIRCLE
ST. PAUL, MINNESOTA 55038-7783

U.S. :: 1-866-438-4884 DIRECT :: 1-651-415-0733
WWW.INNOVATIVETOOLS.COM

INNOVATIVE X-TENDER STAND PART # I-ES

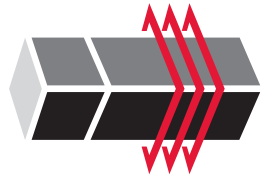
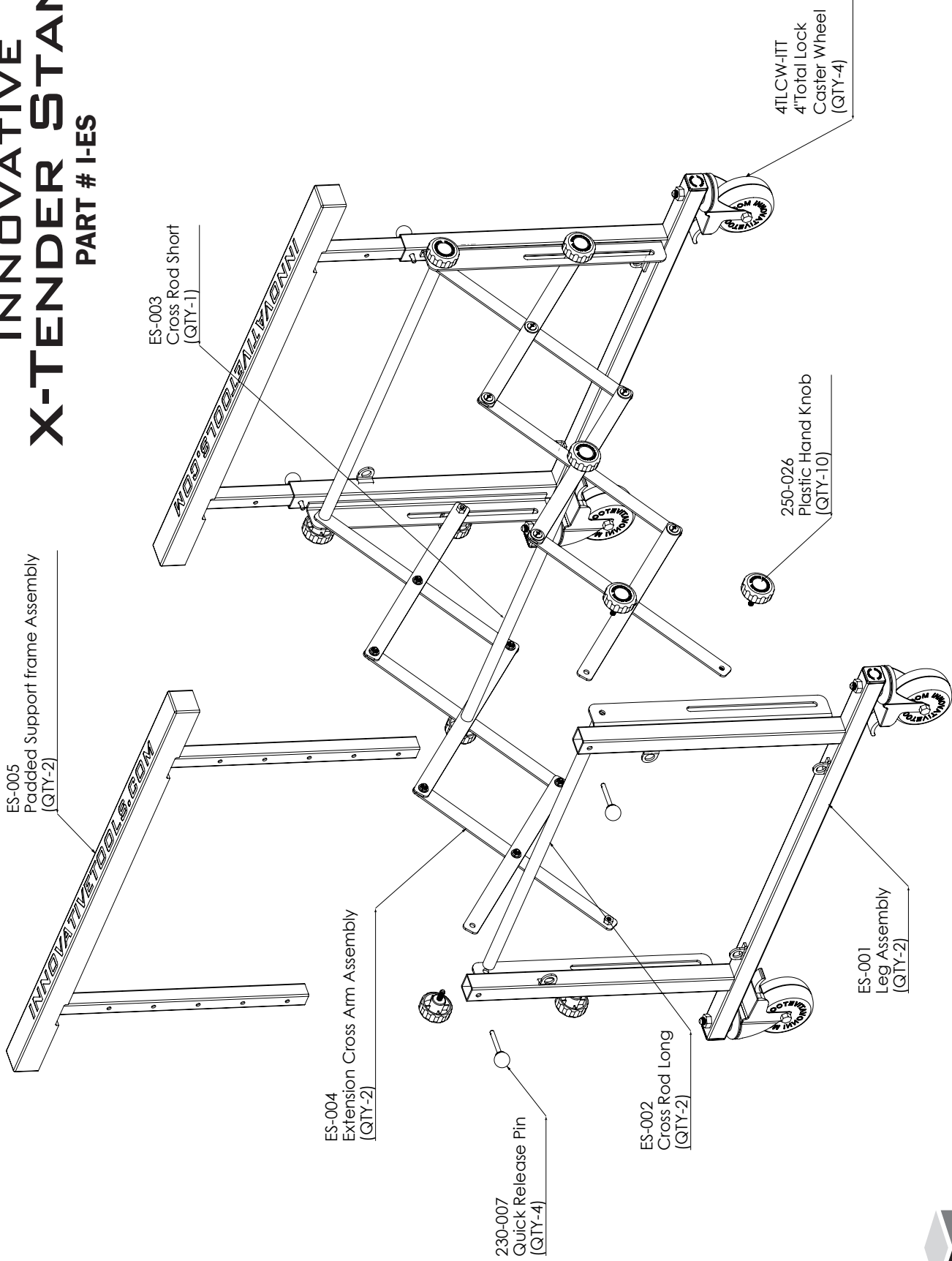

INNOVATIVE
TOOLS & TECHNOLOGIES, INC.
2016 GATEWAY CIRCLE
ST. PAUL, MINNESOTA 55038-7783

For comments, questions, or concerns about products or missing parts, contact us at:

TOLL FREE 1-866-438-4884 1-651-415-0733

WWW.INNOVATIVETOOLS.COM